

PROPERTY FOR SALE

Location Map

Parcel 5: Houghton County, Michigan – South Sidnaw 40 Acres

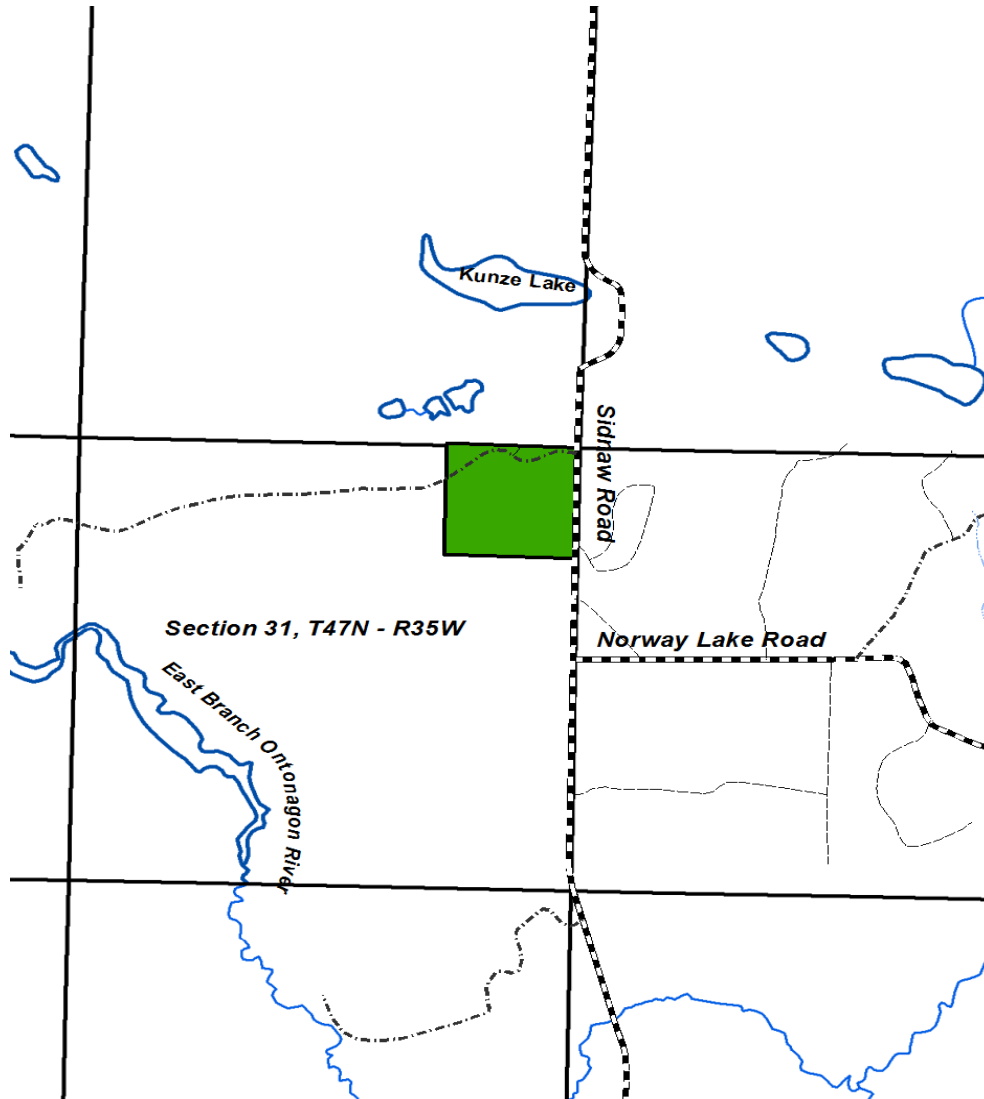

This 40 acre tract lies 5 miles south of the village of Sidnaw and Highway M28. The parcel fronts on Sidnaw Road providing year around access. The property sits in the heart of the Ottawa National Forest that opens boundless opportunities for hunting, boating, fishing and many other outdoor recreation activities. The property is all upland and has a diverse mix of young jack pine, mature red and white pine, aspen and hardwood. Your neighbors include National Forest property and other commercial forest lands open for recreation. Asking price is \$66,000. Legal Description: NE1/4 of the NE1/4, Section 31, T47N – R35W, Houghton County, Michigan.