

PROPERTY FOR SALE

GENERAL LAND COVER

Parcel 12 – Gogebic County Middle Branch Ontonagon River

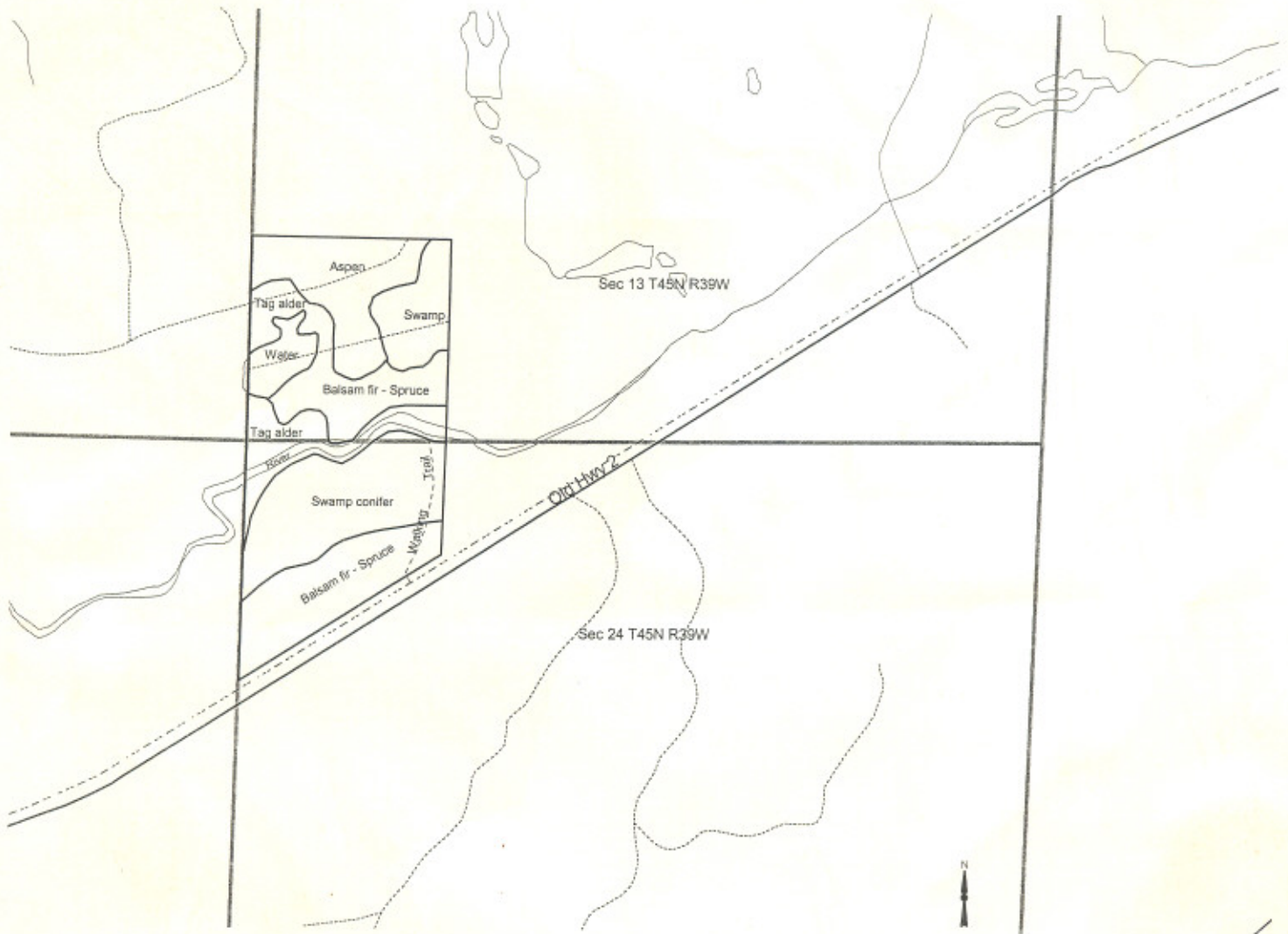

This parcel is approximately 70 acres located 2.5 miles northeast of Watersmeet. It has access on County Road 208 and borders an active recreational trail (a DNR permit will be required to have a driveway across the trail). The property includes 1,500 feet of frontage on the Middle Branch of the Ontonagon River. The river travels E-W across the middle of the property. Potential cabin sites overlook the river. The parcel has 15 acres of aspen, 15 acres of lowland brush and floodings, 10 acres of upland balsam, and about 30 acres of mixed lowland conifers. Topography varies from level to rolling. Asking \$95,000. Legal Description: The SW ¼ - SW ¼ Section 13, and the W ½ - NW ¼ (lying north and west of the rail road grade), Section 24, T45N-R39W, Watersmeet Township, Gogebic County.

