

PROPERTY FOR SALE

Location Map

Parcel 1: Dickinson County, Michigan - Browns Lake Road '40'

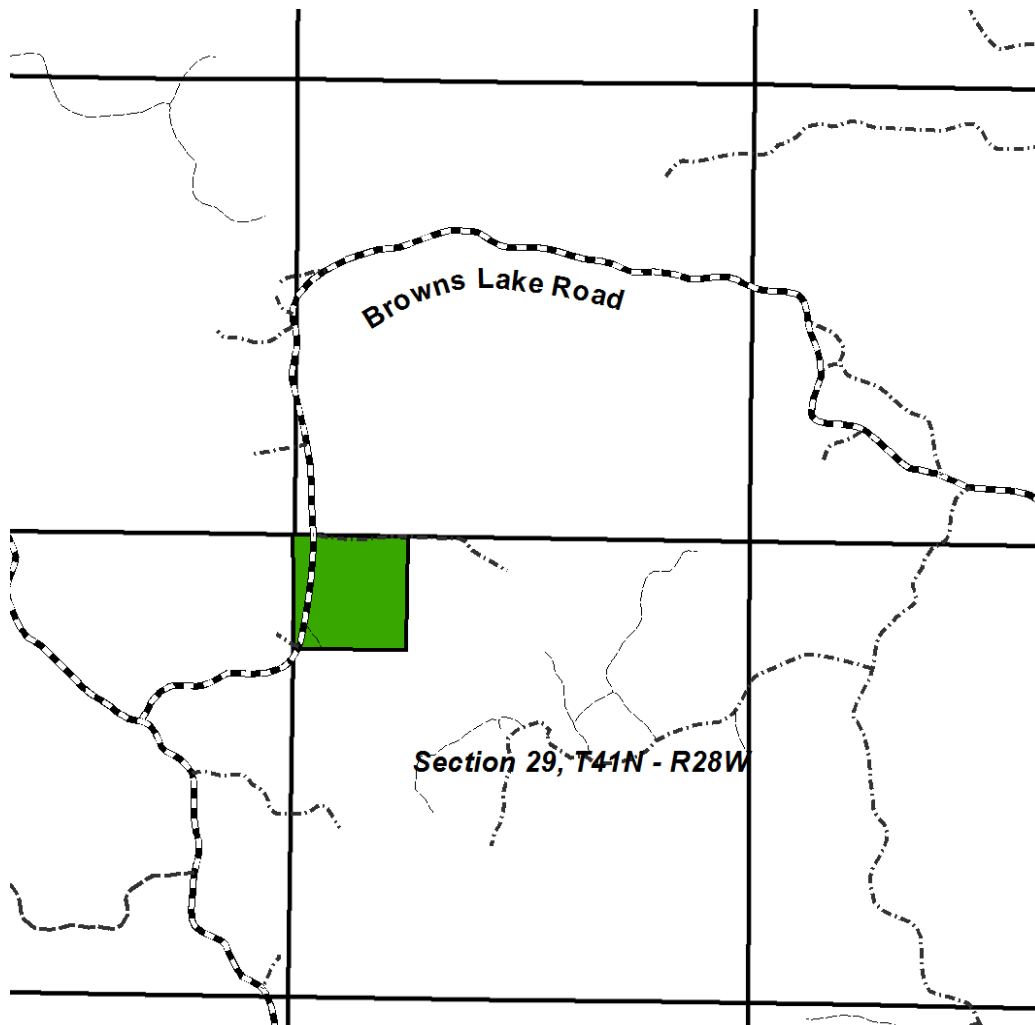

This 40 acre tract and is about 18 miles north and east of Iron Mountain and 12 miles north of US Highway 2. Browns Lake Road runs through the western edge of the property providing excellent year-round access. It's forested with 30 year old aspen, some oak and pine and is almost all upland. The area is known for excellent hunting and sits immediately adjacent to State of Michigan Forest land that is open for public recreation. Asking price is \$68,000. Legal Description: NW1/4 of the NW1/4, Section 29, T41N – R28W, Dickinson County.